

CORNER RECORD

Agency Index

BK 128 PG 9

Document Number

CR 13206

City of EDEN TOWNSHIP

County of ALAMEDA, California

Brief Legal Description RAILROAD SPIKE MONUMENT LOCATED WITHIN SUNSET BLVD AT VALLEJO ST

CORNER TYPE

COORDINATES (Optional)

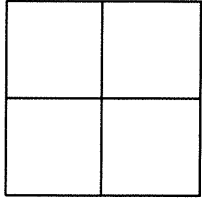

Government Corner ☐ Control ☒
Meander ☐ Property ☐
Rancho ☐ Other ☐

Date of Survey 8/1/19

N. E.

Elevation

Units Metric ☐ U.S. Survey Foot ☐

Horizontal Datum

Zone Epoch Date

Vertical Datum

☐ Complies with Public Resources Code §§8801-8819☐ Complies with Public Resources Code §§8890-8902PLS Act Ref: ☐ 8765 (d) ☒ 8771 ☐ 8773 ☐ Other:

Corner/Monument: ☒ Left as found ☐ Established ☐ Rebuilt ☒ Pre-Construction
☐ Found and tagged ☐ Reestablished ☒ Referenced ☐ Post-Construction

Narrative of corner identified and monument as found, set, reset, replaced, or removed:

☐ See sheet #2 for description (s):
FOUND RAILROAD SPIKE WITH CUT CROSS

FOUND AND SET POINTS AS SHOWN ON PAGE 2.

THIS POINT WAS REFERENCED PRIOR TO A CONSTRUCTION PROJECT IN THE VICINITY.

THE TIES SHOWN HEREON ARE FOR THE PURPOSE OF PERPETUATING FOUND MONUMENTATION.
NO CLAIM IS MADE AS TO THE RELATIONSHIP OF THE POINTS OR LINES SHOWN HEREON TO TRUE
BOUNDARY LOCATION.

SURVEYOR'S STATEMENT

This Corner Record was prepared by me or under my direction in conformance with

the Professional Land Surveyors' Act on AUGUST 5, 2019.

Signed SCOTT V. CUNHA P.L.S. or R.C.E. No. LS 8525

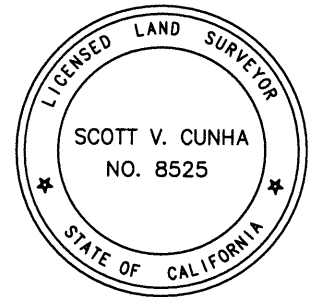

COUNTY SURVEYOR'S STATEMENT

AUG 07 2019

This Corner Record was received

and examined and filed NOV 18 2019

Signed D. Ian Wilson P.L.S. or R.C.E. No. 7010

Title **ALAMEDA COUNTY SURVEYOR**

County Surveyor's Comment

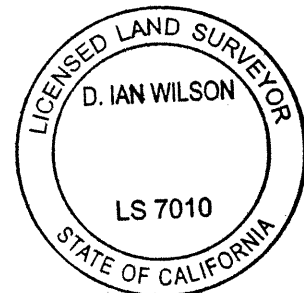

SPEC-2377-Pre

SCALE: 1"=30'

LEGEND

△ FOUND RAILROAD SPIKE WITH CUT CROSS

✕ SET CUT CROSS IN CURB

(19592) REFERENCE STREET ADDRESS

