



PANDA EXPRESS, INC.  
1683 Walnut Grove Ave.  
Rosemead, California  
91770  
Telephone: 626.799.9898  
Facsimile: 626.372.8288

All ideas, designs, arrangement and plans indicated or represented by this drawing are the property of Panda Express Inc. and were created for use on this specific project. None of these ideas, designs, arrangements or plans may be used by or disclosed to any person, firm, or corporation without the written permission of Panda Express Inc.

REVISIONS:		

ISSUE DATE:		
ISSUE FOR PERMIT	01-29-21	
ISSUE FOR BID	04-30-21	
ISSUE FOR BID 2	11-02-21	
ISSUE FOR BID (DT)	02-04-22	

DRAWN BY: AE

PANDA PROJECT #: D8164  
PANDA STORE #: -  
ARCH PROJECT #: 261-321



MPW ENGINEERING, LLC  
110 W. 7TH STREET • SUITE 600 • TULSA, OK 74119  
(918) 582-4088 • (918) 582-4087 FAX



PANDA EXPRESS  
TRUE WARM & WELCOME  
JEFFERSON AVE. & MORRIS DR.  
NEWPORT NEWS, VA 23605

E-101.1

CANOPY LIGHTING PLAN

TRUE WARM & WELCOME 2300 R6

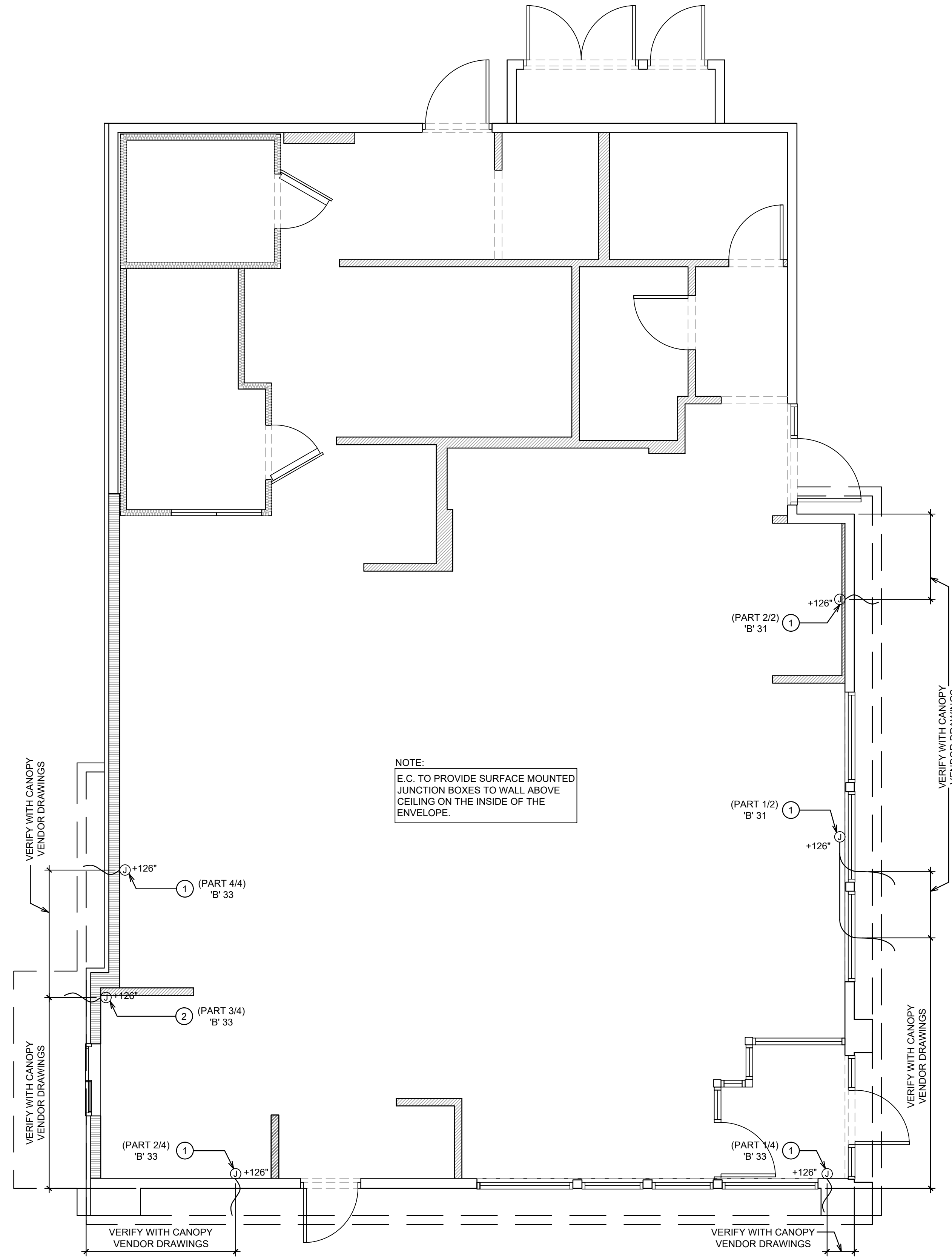

1. E.C. TO PROVIDE J-BOX WITH 3' WHIP FOR CONNECTION TO PANDA EXPRESS PROVIDED LIGHTED CANOPY. E.C. TO MAKE FINAL CONNECTION.	
2. E.C. TO PROVIDE J-BOX WITH 3' WHIP FOR CONNECTION TO PANDA EXPRESS PROVIDED LIGHTED DRIVE THRU CANOPY. E.C. TO MAKE FINAL CONNECTION.	
3. ALL JUNCTION BOXES ON THIS SHEET TO BE RECESS MOUNTED.	
#	2
CANOPY LIGHTING KEYED NOTES	
NOT TO SCALE	E-101.1

CANOPY LIGHTING PLAN	
1	1
Scale: 1/4"=1'-0"	E-101.1