

CORNER RECORD

Document Number CK 9049

City of San Leandro County of Alameda, California

Brief Legal Description Monumento Dartmouth and Corvallis

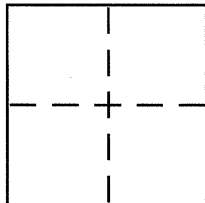

CORNER TYPE

Government Corner ☐ Control ☐

Meander ☐ Property ☐

Rancho ☐ Other ☐

Date of Survey 10 04 14

COORDINATES (Optional)

N. 6-RI

E. De Pkew

Zone _____ NAD27 ☐ NAD83 ☐

NAD83 Epoch

Elev.

Vert. Datum: NGVD29 ☐ NAVD88 ☐

Meas. Units: Metric ☒ Imperial ☐

Corner – Left as found ☒ Found and tagged ☐ Established ☐ Reestablished ☐ Rebuilt ☐

Identification and type of corner found: Evidence used to identify or procedure used to establish or reestablish the corner:

Per Section 87716 of the Business and Professions Code
this monument was referenced ~~prior~~ after a
construction project in the vicinity

Reference "Prior Construction" CR 8268 bk 79 pg 41

A description of the physical condition of the monument as found and as set or reset:

Found in good condition

SURVEYOR'S STATEMENT

This Corner Record was prepared by me or under my direction in conformance with the Land Surveyor's Act on 02/01/2016.

the Land Surveyor's Act on 10/7/2016
Signed [Signature] P.L.S or ~~P.C.~~ No. 5254

COUNTY SURVEYOR'S STATEMENT

This Corner Record was received 6 OCTOBER, 2016

and examined and filed 31 OCTOBER 2016

Signed Michael Rob P.L.S or ~~P.C.E.~~ No. 6843

Title COUNTY SURVEYOR

County Surveyor's Comment

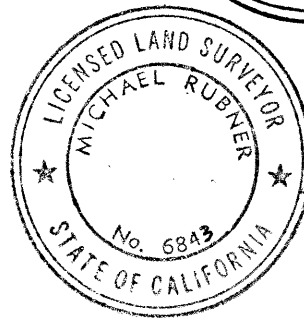
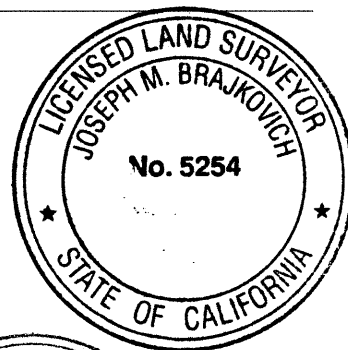

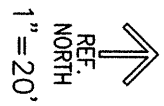

LEGEND

- MONUMENT
- CUT X

