

6" SCHED 40 PVC BEVERAGE CONDUIT DOWN IN WALL. START ABOVE CEILING AND TURN OUT THRU WALL TOWARDS DRIVE THRU DRINK TOWER WITH BOTTOM EDGE OF WALL PENETRATION 0'-8" ABOVE FINISHED FLOOR. LOCATE PENETRATION ALONG WALL AT CENTER OF DRINK TOWER. SEE BEVERAGE CONDUIT NOTE #5.

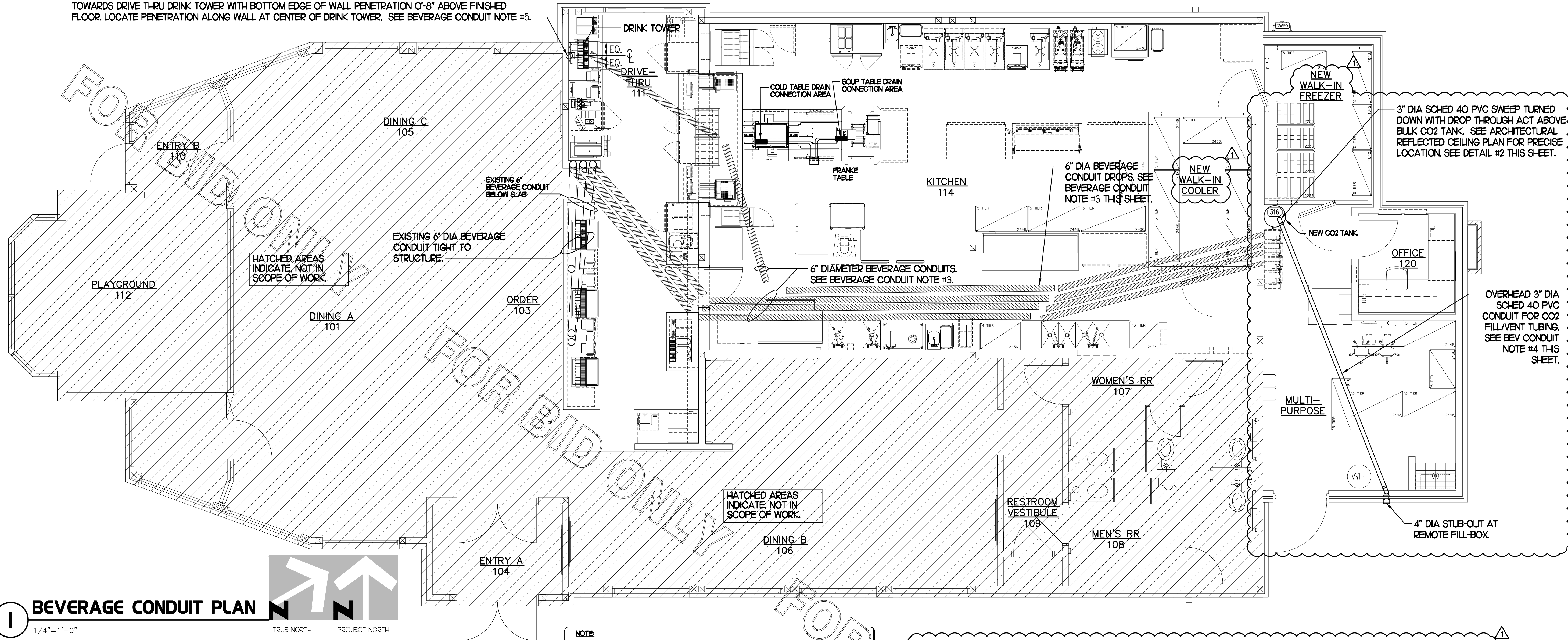

3. BEVERAGE CONDUIT NOTES

- ROUTE BEVERAGE SYSTEM PIPING OVER-HEAD FROM THE BEVERAGE RACK TO DRINK TOWERS IN FOUR (4)-6" DIA SCH 40 PVC DWV CONDUITS. ALL CONDUIT SHALL BE HELD TIGHT TO STRUCTURE AND SUPPORTED WITH THREADED ROD AND CLEVIS HANGERS AT INTERVALS SHOWN IN SPECIFICATIONS FOR HORIZONTAL OVER-HEAD PIPING. COORDINATE ROUTING WITH THE GENERAL CONTRACTOR TO AVOID MECHANICAL AND ELECTRICAL SYSTEMS. SEE I/P#1 AND I/P#1 FOR BELOW-SLAB BEVERAGE CONDUIT.
- COORDINATE ROUTING OF ALL CONDUITS WITH HVAC DUCT IN KITCHEN. SEE SHEET MH FOR LOCATION OF AC UNITS AND DUCT ROUTING.
- TURN THE 6" DIA CONDUIT DOWN THROUGH THE CEILING AT THE BEVERAGE RACK AND PROVIDE CHROMED ESCUTCHEONS AT CEILING PENETRATIONS. TERMINATE OPPOSITE END ABOVE CEILING WHERE SHOWN ON PLANS.
- COORDINATE ROUTING OF REMOTE FILL LINE AND LOCATION OF EXTERIOR WALL MOUNTED FILL-BOX WITH COMPRESSED GAS VENDOR DURING CONSTRUCTION.
- AT 6" DIA CONDUIT DROP IN DRIVE-THRU, PROVIDE 1/8TH BEND FITTING WITH SHORT PIPE STUB AT BASE OF DROP. CUT STUB AND FITTING FLUSH WITH FINISHED WALL.
- FOR BEVERAGE CONDUIT DROPS AT WALLS WITH SHEATHING EXTENDED ABOVE THE CEILING, PROVIDE APPROPRIATE FITTING TO AT UPPER END OF CONDUIT DROP TO EXTEND CONDUIT THROUGH SHEATHING.

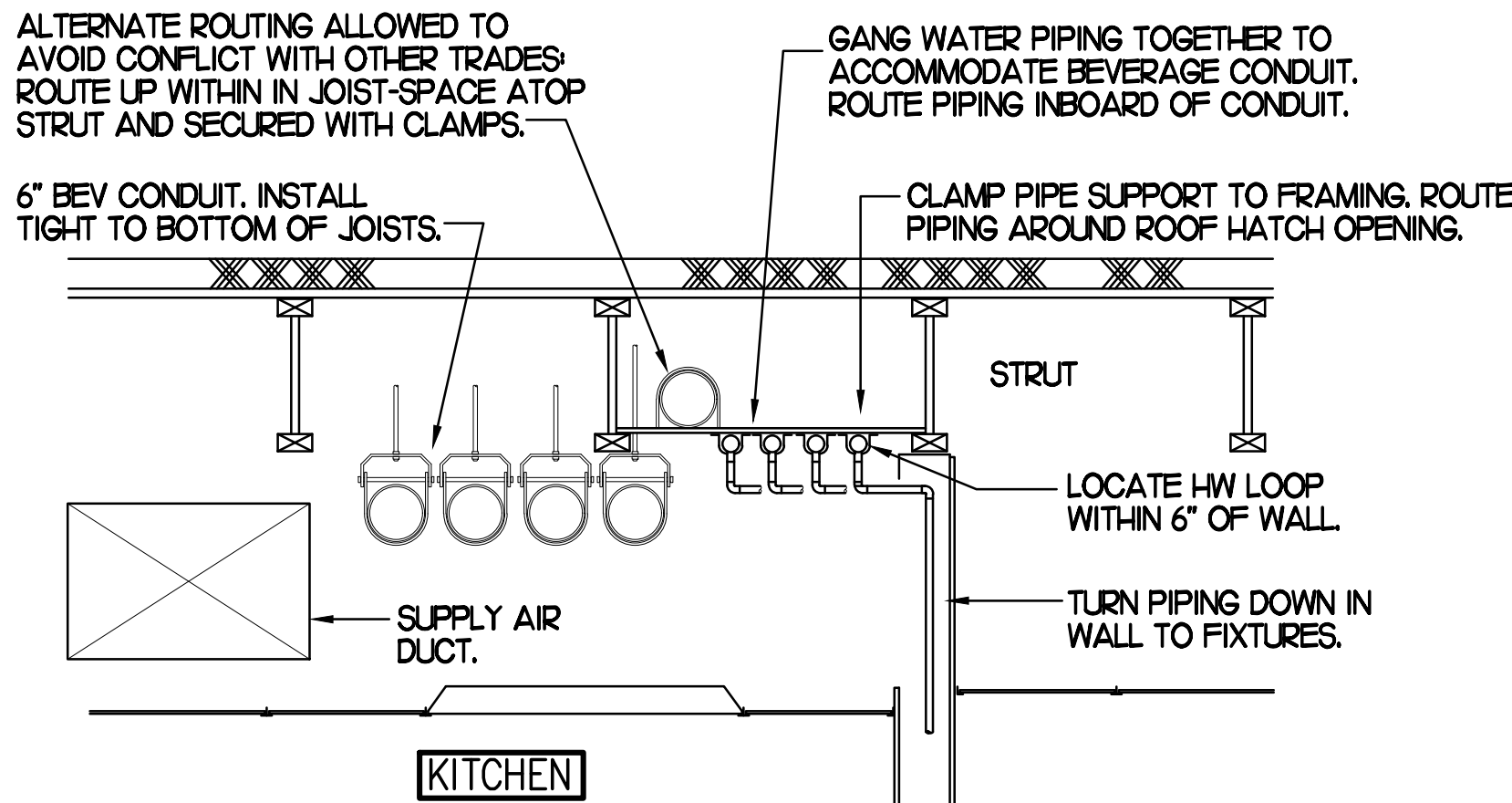

2 SECTION AT WET WALL

1/4"=1'-0"

NOTE:
ALL BEVERAGE CONDUIT LAYOUTS ARE SCHEMATIC. EXACT LOCATIONS SHALL BE DETERMINED BY THE CONSTRUCTION AND STRUCTURE OF THE BUILDING AND SHALL BE VERIFIED AND COORDINATED IN THE FIELD TO REVIEW ALL NEW & EXISTING EQUIPMENTS. EACH TRADE CONTRACTOR SHALL VERIFY WITH THE GENERAL CONTRACTOR THAT HAS THOROUGHLY REVIEWED AND COORDINATED ALL LOCATIONS AND ROUTINGS WITH ALL OTHER TRADES PRIOR TO INSTALLATION & FABRICATION OF CONDUITS, DUCTS, OR PIPING. RUN BEVERAGE CONDUITS AS STRAIGHT AS POSSIBLE AVOIDING EXISTING STRUCTURE, PIPING, DUCTS, & ALL EQUIPMENTS. ANY INSTALLATION OR CONSTRUCTION CONFLICTS WHICH OCCUR IN THE FIELD SHALL BE RESOLVED BY THE TRADE CONTRACTOR TO THE SATISFACTION OF THE OWNER AND ARCHITECT AND AT NO EXPENSE TO THE OWNER, ARCHITECT AND/OR GENERAL CONTRACTOR.

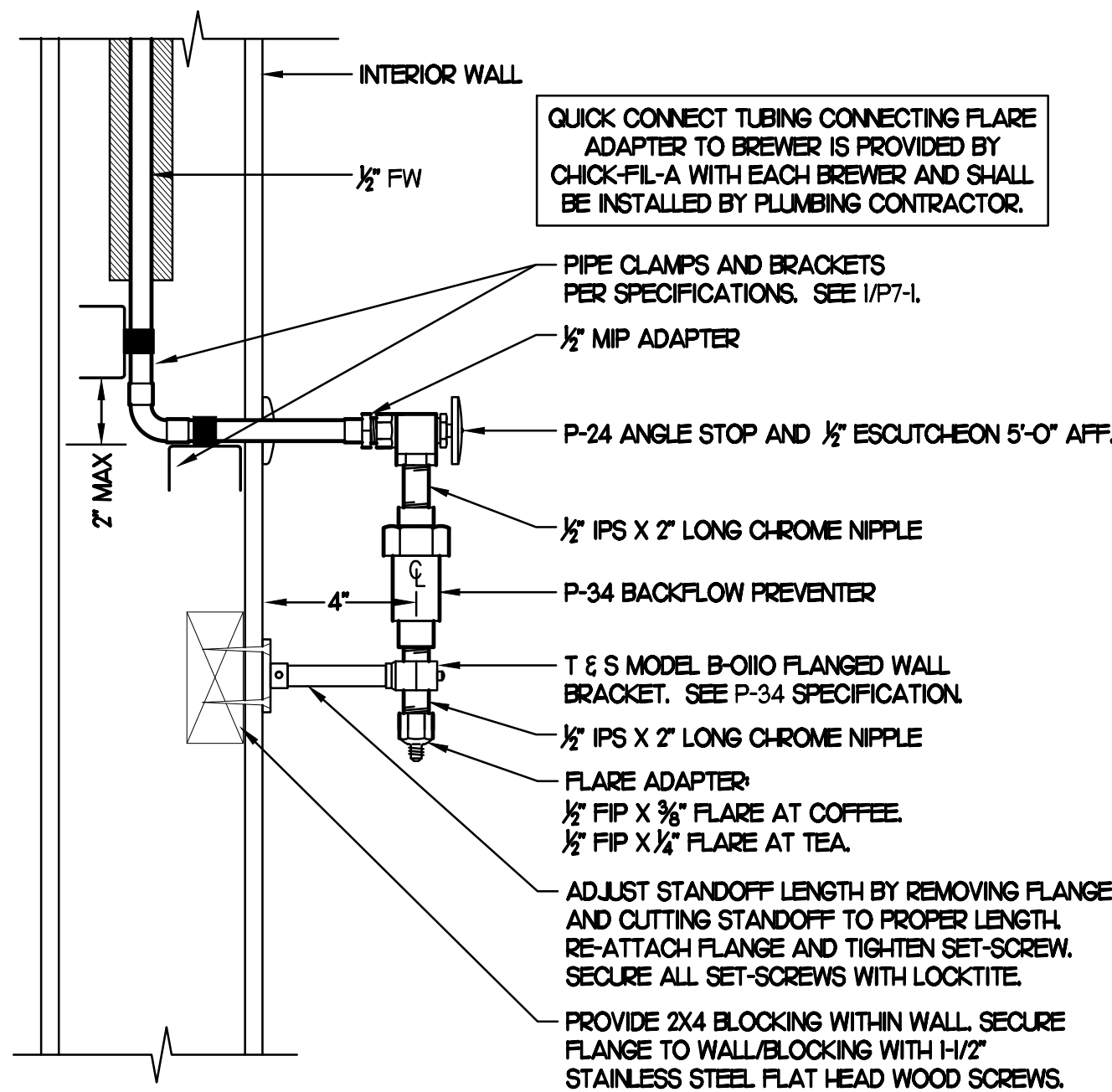

3 COFFEE & TEA BREWER STOP & BFP

SCALE: NONE

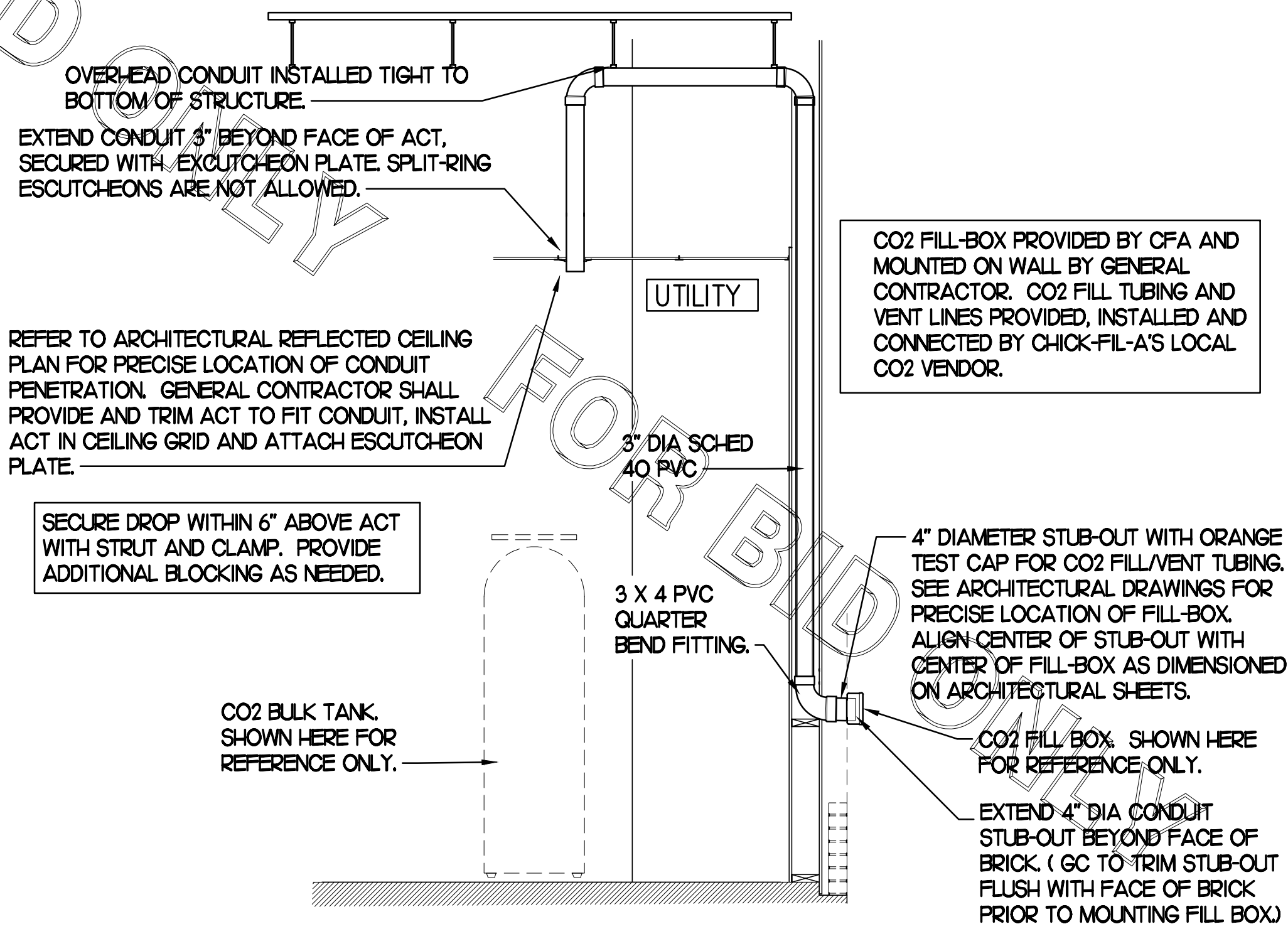

4 CO2 FILL/VENT CONDUIT AND FILL-BOX INSTALLATION

SCALE: NONE

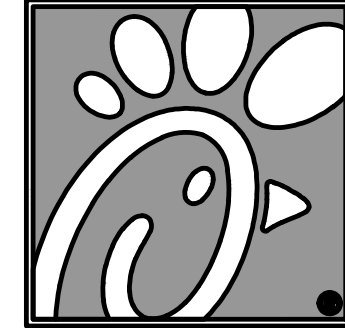

Chick-fil-A

5200 Buffington Rd.
Atlanta Georgia,
30349-2998

Revisions:

Mark Date By
1 12/14/17 JL
OPERATOR

COMMENTS

△

△

△

△

SEAL

THIS DOCUMENT IS NOT FOR CONSTRUCTION

UNLESS THE ARCHITECT OR ENGINEER'S

SIGNATURE AND SEAL APPEAR BELOW.

STACY HENSON, P.E.

INTERPLAN

ARCHITECTURE
ENGINEERING
INTERIOR DESIGN
PROJECT MANAGEMENT

604 COURTLAND STREET
SUITE 100
ORLANDO, FLORIDA 32804
PH 407.645.5008
FX 407.629.9124

STORE
S97-100
Jimmy Carter Blvd
FSU #0745

5455 Jimmy Carter Blvd
GA, 30093-1512

SHEET TITLE
PLUMBING DETAILS
& BEVERAGE
CONDUIT

VERSION: V7.025
ISSUE DATE: 01-2017

Job No. : 17.0522

Store : 0745

Date : 10.09.17

Drawn By : LE

Checked By: JL

Sheet

P-2.2